

# ZERO•NET™

## US8375

### UNITIZED CURTAIN WALL

The **US8375**, our standard **unitized curtain wall** system, has been a staple in building construction since 1996, during the FM Enterprise era. This system is a conventional thermally broken unitized curtain wall system.

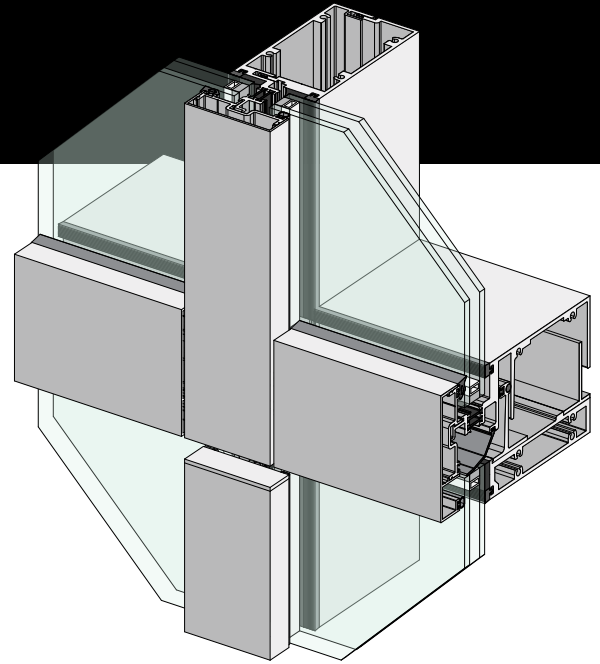

### FEATURES

- Mid to high-rise application
- Shop glazed
- System depth - 7 3/8" to 8 3/8"
- 2 1/2" or 3" mullion sightlines (can accommodate custom sizes)
- Can accommodate infills up to 1 3/4" for greater thermal performance
- Furnished in captured or SSG
- Exterior sunshades and interior light shelves are available
- System performance is driven by glass



**Kean University**  
Union, NJ  
Gruskin Group

#### CAPTURED

U-Factor Center of Glass (Btu/h-ft <sup>2</sup> -F)	U-Factor Assembled (Btu/h-ft <sup>2</sup> -F)	SHGC	VT	CR
0.244	0.315	0.202	0.394	68.7

#### SSG

U-Factor Center of Glass (Btu/h-ft <sup>2</sup> -F)	U-Factor Assembled (Btu/h-ft <sup>2</sup> -F)	SHGC	VT	CR
0.243	0.337	0.342	0.616	65