

# ENVIRONMENTAL PRODUCT DECLARATION

## IN ACCORDANCE WITH EN 15804+A2 & ISO 14025 / ISO 21930

UCW3500 Unitized Curtain Wall  
FreMarq Innovations

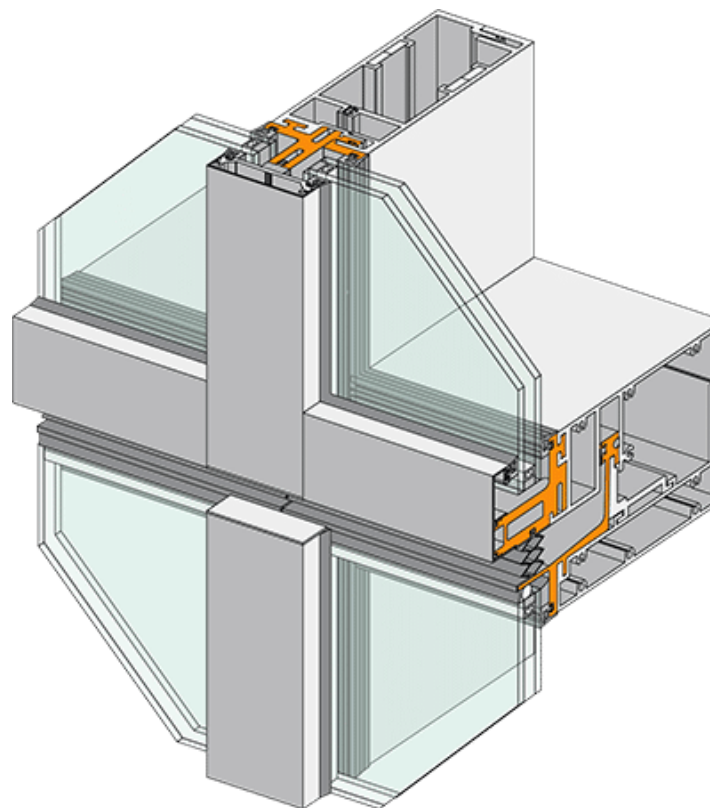

**EPD HUB, HUB-1306**

Published on 16.04.2024, last updated on 16.04.2024, valid until 16.04.2029.

## GENERAL INFORMATION

### MANUFACTURER

Manufacturer	FreMarq Innovations
Address	1101 North Mill Street, Merrill, WI 54452
Contact details	info@fremarq.com
Website	https://www.fremarqinnovations.com/

### EPD STANDARDS, SCOPE AND VERIFICATION

Program operator	EPD Hub, hub@epdhub.com
Reference standard	EN 15804+A2:2019 and ISO 14025
PCR	EPD Hub Core PCR version 1.0, 1 Feb 2022 EN 17213 Windows and doors
Sector	Manufactured product
Category of EPD	Third party verified EPD
Parent EPD number	
Scope of the EPD	Cradle to gate with modules C1-C4, D
EPD author	Tyler Frederick
EPD verification	Independent verification of this EPD and data, according to ISO 14025: <input type="checkbox"/> Internal verification <input checked="" type="checkbox"/> External verification
EPD verifier	Neena Chandramathy, as an authorized verifier acting for EPD Hub Limited

The manufacturer has the sole ownership, liability, and responsibility for the EPD. EPDs within the same product category but from different programs may not be comparable. EPDs of construction products may not be comparable if they do not comply with EN 15804 and if they are not compared in a building context.

### PRODUCT

Product name	UCW3500 Unitized Curtain Wall
Additional labels	-
Product reference	UCW3500
Place of production	United States
Period for data	October 2021 - October 2022
Averaging in EPD	No averaging
Variation in GWP-fossil for A1-A3	0 %

### ENVIRONMENTAL DATA SUMMARY

Declared unit	1 m <sup>2</sup>
Declared unit mass	68.29692 kg
GWP-fossil, A1-A3 (kgCO <sub>2</sub> e)	2.62E+02
GWP-total, A1-A3 (kgCO <sub>2</sub> e)	2.59E+02
Secondary material, inputs (%)	14.9
Secondary material, outputs (%)	26.6
Total energy use, A1-A3 (kWh)	886
Total water use, A1-A3 (m <sup>3</sup> e)	1.92

## PRODUCT AND MANUFACTURER

### ABOUT THE MANUFACTURER

FreMarq Innovations was founded in 2015 and has been developing new technologies to improve the thermal performance of curtain wall systems. FreMarq Innovations produces unitized curtain wall, pressure wall, and window wall systems that are all custom designed for each customer. FreMarq Innovations is located in Merrill, WI.

### PRODUCT DESCRIPTION

The UCW3500 Unitized Curtain Wall primary function is to be the envelope of a building. The UCW3500 Unitized Curtain Wall made of aluminium, PVC, rubber gaskets, silicone, and fasteners. The materials used in packaging are wood and fasteners. The size of the unit is 1 Meter by 1 Meter

Further information can be found at <https://www.fremarqinnovations.com/>.

### PRODUCT RAW MATERIAL MAIN COMPOSITION

Raw material category	Amount, mass- %	Material origin
Metals	24.32	Aluminium-US, Steel-US
Minerals	58.954	Glass Fibres from US, Glass Pane from US
Fossil materials	13.4	Rubber, Silicone, PVC-US
Bio-based materials	-	Not Applicable

### BIOGENIC CARBON CONTENT

Product's biogenic carbon content at the factory gate

Biogenic carbon content in product, kg C	0
Biogenic carbon content in packaging, kg C	0.50315

### FUNCTIONAL UNIT AND SERVICE LIFE

Declared unit	1 m <sup>2</sup>
Mass per declared unit	68.29692 kg

### SUBSTANCES, REACH - VERY HIGH CONCERN

The product does not contain any REACH SVHC substances in amounts greater than 0,1 % (1000 ppm).

# PRODUCT LIFE-CYCLE

## SYSTEM BOUNDARY

This EPD covers the life-cycle modules listed in the following table.

Product stage			Assembly stage		Use stage							End of life stage				Beyond the system boundaries		
A1	A2	A3	A4	A5	B1	B2	B3	B4	B5	B6	B7	C1	C2	C3	C4	D		
x	x	x	MND	MND	MND	MND	MND	MND	MND	MND	MND	x	x	x	x	x		
Raw materials	Transport	Manufacturing	Transport	Assembly	Use	Maintenance	Repair	Replacement	Refurbishment	Operational energy use	Operational water use	Deconstr./demol.	Transport	Waste processing	Disposal	Reuse	Recovery	Recycling

Modules not declared = MND. Modules not relevant = MNR.

### MANUFACTURING AND PACKAGING (A1-A3)

The environmental impacts considered for the product stage cover the manufacturing of raw materials used in the production as well as packaging materials and other ancillary materials. Also, fuels used by machines, and handling of waste formed in the production processes at the manufacturing facilities are included in this stage. The study also considers the material losses occurring during the manufacturing processes as well as losses during electricity transmission.

All the raw materials are produced outside of our factory. The manufacturing process requires electricity and fuels for the different equipment. In the factory, raw materials including aluminium, steel, glass and silicon, as well as pre-fabricated components, such as rubber gasket and screws are first put through quality check. All materials are then sorted and prepped for fabrication. The extrusions and PVC are sent to the saw

and through machining centers. They are then assembled into the windows and this is where the screws and rubber silicone gaskets are added to the windows. We then set the glass on our frames using an overhead crane. The frames move down the line on roller beds and have silicone shot between the glass and aluminium to create a seal. Once the windows are shot with silicone, we add the caps to the windows to hold the glass in place. Once the silicone is set after 4 hours, we pack them into wood skids that are made from Pine Wood and fasteners. These filled crates are stored indoors and shipped on a trailer to the job site. Energy data collected from year 2022 based on link: <https://www.eia.gov/state/?sid=W1>.

### TRANSPORT AND INSTALLATION (A4-A5)

Transportation impacts occurred from final products delivery to construction site (A4) cover fuel direct exhaust emissions, environmental impacts of fuel production, as well as related infrastructure emissions.

Was not considered in this study.

### PRODUCT USE AND MAINTENANCE (B1-B7)

This EPD does not cover the use phase.

Air, soil, and water impacts during the use phase have not been studied.

### PRODUCT END OF LIFE (C1-C4, D)

The construction of the waste processing facility and the appropriate equipment are not a part of this model. Power tools and heavy machinery are used to remove the curtain wall into its appropriate end of life stream. Due to the material and energy recovery potential of the materials, a part of the end-of-life product is converted into recycled raw materials while electric and heat energy are generated from incineration. The wood pallet

is incinerated, where the energy recovered from incineration displaces electricity and heat production. The aluminium is separated and 100% is recycled. Manufacturing waste and loss including metal scraps are sent 1328 km away to a waste manager for recycling. The rest of the materials and components are landfilled at the end of deconstruction.

# MANUFACTURING PROCESS

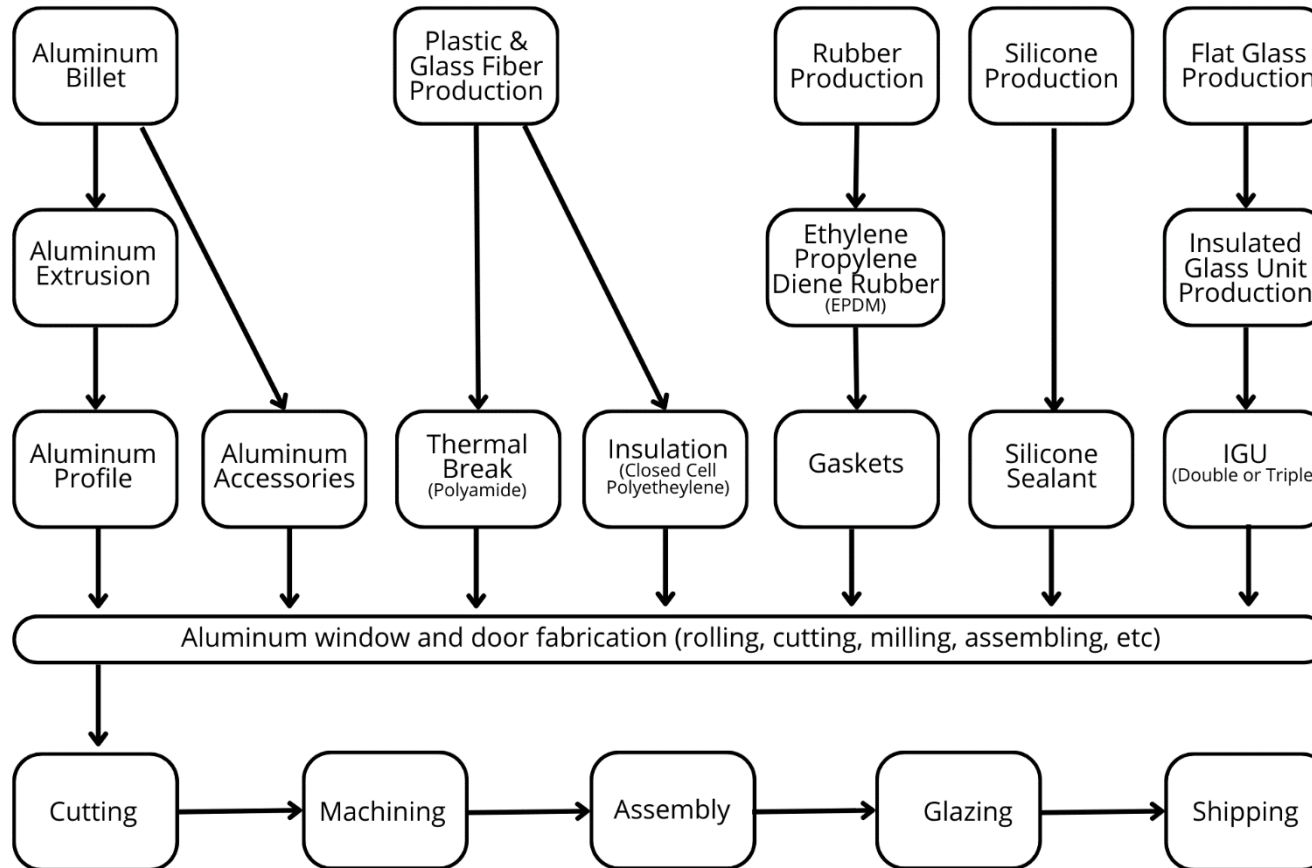

## LIFE-CYCLE ASSESSMENT

### CUT-OFF CRITERIA

The study does not exclude any modules or processes which are stated mandatory in the reference standard and the applied PCR. The study does not exclude any hazardous materials or substances. The study includes all major raw material and energy consumption. All inputs and outputs of the unit processes, for which data is available for, are included in the calculation. There is no neglected unit process more than 1% of total mass or energy flows. The module specific total neglected input and output flows also do not exceed 5% of energy usage or mass.

### ALLOCATION, ESTIMATES AND ASSUMPTIONS

Allocation is required if some material, energy, and waste data cannot be measured separately for the product under investigation. All allocations are done as per the reference standards and the applied PCR. In this study, allocation has been done in the following ways:

Data type	Allocation
Raw materials	Allocated by mass or volume
Packaging materials	Allocated by mass or volume
Ancillary materials	Allocated by mass or volume
Manufacturing energy and waste	Allocated by mass or volume

### AVERAGES AND VARIABILITY

Type of average	No averaging
Averaging method	Not applicable
Variation in GWP-fossil for A1-A3	0 %

There is no average result considered in this study since EPD refers to one specific product produced in one production plant.

### LCA SOFTWARE AND BIBLIOGRAPHY

This EPD has been created using One Click LCA EPD Generator. The LCA and EPD have been prepared according to the reference standards and ISO 14040/14044. The EPD Generator uses Ecoinvent v3.8, Plastics Europe, Federal LCA Commons and One Click LCA databases as sources of environmental data.

# ENVIRONMENTAL IMPACT DATA

## CORE ENVIRONMENTAL IMPACT INDICATORS – EN 15804+A2, PEF

Impact category	Unit	A1	A2	A3	A1-A3	A4	A5	B1	B2	B3	B4	B5	B6	B7	C1	C2	C3	C4	D
GWP – total <sup>1)</sup>	kg CO <sub>2</sub> e	2.44E+02	3.83E+00	1.13E+01	2.59E+02	MND	0.00E+00	MND	MND	MND	MND	MND	MND	MND	4.13E-01	0.00E+00	3.30E+00	1.45E+00	-3.88E+01
GWP – fossil	kg CO <sub>2</sub> e	2.43E+02	3.83E+00	1.48E+01	2.62E+02	MND	0.00E+00	MND	MND	MND	MND	MND	MND	MND	4.12E-01	0.00E+00	4.49E-01	1.45E+00	-3.24E+01
GWP – biogenic	kg CO <sub>2</sub> e	5.04E-01	1.52E-03	-3.47E+00	-2.97E+00	MND	0.00E+00	MND	MND	MND	MND	MND	MND	MND	3.66E-04	0.00E+00	2.85E+00	2.82E-03	-5.91E+00
GWP – LULUC	kg CO <sub>2</sub> e	1.72E-01	1.38E-03	1.73E-03	1.75E-01	MND	0.00E+00	MND	MND	MND	MND	MND	MND	MND	8.57E-04	0.00E+00	5.98E-04	4.60E-04	-5.28E-01
Ozone depletion pot.	kg CFC <sub>11</sub> e	2.03E-05	9.15E-07	8.66E-07	2.21E-05	MND	0.00E+00	MND	MND	MND	MND	MND	MND	MND	1.26E-08	0.00E+00	4.60E-08	1.57E-07	-2.61E-06
Acidification potential	mol H <sup>+</sup> e	1.95E+00	1.60E-02	9.21E-02	2.06E+00	MND	0.00E+00	MND	MND	MND	MND	MND	MND	MND	1.79E-03	0.00E+00	4.95E-03	4.26E-03	-3.47E-01
EP-freshwater <sup>2)</sup>	kg Pe	1.13E-02	2.62E-05	4.82E-04	1.18E-02	MND	0.00E+00	MND	MND	MND	MND	MND	MND	MND	5.98E-05	0.00E+00	1.96E-05	6.05E-06	-4.03E-04
EP-marine	kg Ne	2.86E-01	4.84E-03	1.49E-02	3.05E-01	MND	0.00E+00	MND	MND	MND	MND	MND	MND	MND	2.13E-04	0.00E+00	1.05E-03	2.58E-03	-2.87E-02
EP-terrestrial	mol Ne	3.15E+00	5.33E-02	1.65E-01	3.37E+00	MND	0.00E+00	MND	MND	MND	MND	MND	MND	MND	2.40E-03	0.00E+00	1.21E-02	1.63E-02	-3.62E-01
POCP (“smog”) <sup>3)</sup>	kg NMVOCe	9.02E-01	1.72E-02	4.60E-02	9.65E-01	MND	0.00E+00	MND	MND	MND	MND	MND	MND	MND	6.85E-04	0.00E+00	3.31E-03	4.90E-03	-1.25E-01
ADP-minerals & metals <sup>4)</sup>	kg Sbe	2.25E-03	8.99E-06	3.19E-06	2.26E-03	MND	0.00E+00	MND	MND	MND	MND	MND	MND	MND	2.29E-06	0.00E+00	4.81E-05	1.61E-06	-7.45E-05
ADP-fossil resources	MJ	2.90E+03	5.86E+01	3.24E+01	2.99E+03	MND	0.00E+00	MND	MND	MND	MND	MND	MND	MND	5.10E+00	0.00E+00	5.38E+00	1.15E+01	-2.65E+02
Water use <sup>5)</sup>	m <sup>3</sup> e depr.	9.47E+01	2.71E-01	7.02E+00	1.02E+02	MND	0.00E+00	MND	MND	MND	MND	MND	MND	MND	9.72E-02	0.00E+00	9.22E-02	5.66E-02	-5.90E+01

1) GWP = Global Warming Potential; 2) EP = Eutrophication potential. Required characterisation method and data are in kg P-eq. Multiply by 3,07 to get PO<sub>4</sub>e; 3) POCP = Photochemical ozone formation; 4) ADP = Abiotic depletion potential; 5) EN 15804+A2 disclaimer for Abiotic depletion and Water use and optional indicators except Particulate matter and Ionizing radiation, human health. The results of these environmental impact indicators shall be used with care as the uncertainties on these results are high or as there is limited experience with the indicator.

## ADDITIONAL (OPTIONAL) ENVIRONMENTAL IMPACT INDICATORS – EN 15804+A2, PEF

Impact category	Unit	A1	A2	A3	A1-A3	A4	A5	B1	B2	B3	B4	B5	B6	B7	C1	C2	C3	C4	D
Particulate matter	Incidence	1.66E-05	4.50E-07	2.00E-07	1.73E-05	MND	0.00E+00	MND	MND	MND	MND	MND	MND	MND	1.02E-08	0.00E+00	6.68E-08	8.77E-08	-5.02E-06
Ionizing radiation <sup>6)</sup>	kBq U235e	1.52E+01	3.02E-01	2.60E+00	1.81E+01	MND	0.00E+00	MND	MND	MND	MND	MND	MND	MND	5.03E-02	0.00E+00	3.30E-02	5.20E-02	-4.28E-01
Ecotoxicity (freshwater)	CTUe	6.10E+03	4.87E+01	1.39E+02	6.29E+03	MND	0.00E+00	MND	MND	MND	MND	MND	MND	MND	4.95E+00	0.00E+00	2.42E+01	1.17E+01	-1.02E+03
Human toxicity, cancer	CTUh	4.36E-07	1.29E-09	2.90E-09	4.40E-07	MND	0.00E+00	MND	MND	MND	MND	MND	MND	MND	1.33E-10	0.00E+00	7.15E-10	3.51E-10	-2.10E-07
Human tox. non-cancer	CTUh	5.13E-06	5.16E-08	7.03E-08	5.25E-06	MND	0.00E+00	MND	MND	MND	MND	MND	MND	MND	4.62E-09	0.00E+00	3.07E-08	5.85E-09	-1.25E-06



SQP <sup>7)</sup>	-	8.73E+02	6.83E+01	1.46E+02	1.09E+03	MND	0.00E+00	MND	MND	MND	MND	MND	MND	MND	MND	8.95E-01	0.00E+00	1.01E+01	2.93E+01	1.91E+02
-------------------	---	----------	----------	----------	----------	-----	----------	-----	-----	-----	-----	-----	-----	-----	-----	----------	----------	----------	----------	----------

6) EN 15804+A2 disclaimer for ionizing radiation, human health. This impact category deals mainly with the eventual impact of low dose ionizing radiation on human health of the nuclear fuel cycle. It does not consider effects due to possible nuclear accidents, occupational exposure nor due to radioactive waste disposal in underground facilities. Potential ionizing radiation from the soil, from radon and from some construction materials is also not measured by this indicator; 7) SQP = Land use related impacts/soil quality.

## USE OF NATURAL RESOURCES

Impact category	Unit	A1	A2	A3	A1-A3	A4	A5	B1	B2	B3	B4	B5	B6	B7	C1	C2	C3	C4	D
Renew. PER as energy <sup>8)</sup>	MJ	1.58E+02	7.59E-01	3.21E+01	1.91E+02	MND	0.00E+00	MND	MND	MND	MND	MND	MND	MND	1.10E+00	0.00E+00	8.12E-01	1.56E-01	-2.84E+02
Renew. PER as material	MJ	0.00E+00	0.00E+00	2.40E+01	2.40E+01	MND	0.00E+00	MND	MND	MND	MND	MND	MND	MND	0.00E+00	0.00E+00	-2.11E+01	0.00E+00	0.00E+00
Total use of renew. PER	MJ	1.58E+02	7.59E-01	5.61E+01	2.15E+02	MND	0.00E+00	MND	MND	MND	MND	MND	MND	MND	1.10E+00	0.00E+00	-2.02E+01	1.56E-01	-2.84E+02
Non-re. PER as energy	MJ	2.70E+03	5.86E+01	2.38E+02	3.00E+03	MND	0.00E+00	MND	MND	MND	MND	MND	MND	MND	5.10E+00	0.00E+00	5.38E+00	1.15E+01	-2.65E+02
Non-re. PER as material	MJ	3.35E+02	0.00E+00	0.00E+00	3.35E+02	MND	0.00E+00	MND	MND	MND	MND	MND	MND	MND	0.00E+00	0.00E+00	0.00E+00	-2.46E+02	0.00E+00
Total use of non-re. PER	MJ	3.03E+03	5.86E+01	2.38E+02	3.33E+03	MND	0.00E+00	MND	MND	MND	MND	MND	MND	MND	5.10E+00	0.00E+00	5.38E+00	-2.34E+02	-2.65E+02
Secondary materials	kg	1.02E+01	1.65E-02	3.98E-02	1.02E+01	MND	0.00E+00	MND	MND	MND	MND	MND	MND	MND	6.19E-04	0.00E+00	5.52E-03	3.99E-03	3.95E+00
Renew. secondary fuels	MJ	1.96E-01	1.46E-04	1.19E-04	1.96E-01	MND	0.00E+00	MND	MND	MND	MND	MND	MND	MND	2.65E-06	0.00E+00	2.75E-04	8.86E-05	-1.39E-03
Non-ren. secondary fuels	MJ	0.00E+00	0.00E+00	0.00E+00	0.00E+00	MND	0.00E+00	MND	MND	MND	MND	MND	MND	MND	0.00E+00	0.00E+00	0.00E+00	0.00E+00	0.00E+00
Use of net fresh water	m <sup>3</sup>	1.82E+00	7.78E-03	8.79E-02	1.92E+00	MND	0.00E+00	MND	MND	MND	MND	MND	MND	MND	3.66E-03	0.00E+00	2.61E-03	1.27E-02	-1.54E+00

8) PER = Primary energy resources.

## END OF LIFE – WASTE

Impact category	Unit	A1	A2	A3	A1-A3	A4	A5	B1	B2	B3	B4	B5	B6	B7	C1	C2	C3	C4	D
Hazardous waste	kg	3.09E+01	6.29E-02	5.06E-01	3.15E+01	MND	0.00E+00	MND	MND	MND	MND	MND	MND	MND	1.60E-02	0.00E+00	4.13E-02	0.00E+00	-1.20E+01
Non-hazardous waste	kg	4.56E+02	1.09E+00	1.96E+01	4.77E+02	MND	0.00E+00	MND	MND	MND	MND	MND	MND	MND	2.77E+00	0.00E+00	1.04E+00	4.97E+01	-2.18E+01
Radioactive waste	kg	6.98E-03	4.04E-04	1.02E-03	8.40E-03	MND	0.00E+00	MND	MND	MND	MND	MND	MND	MND	1.18E-05	0.00E+00	2.30E-05	0.00E+00	-7.27E-04

## END OF LIFE – OUTPUT FLOWS

Impact category	Unit	A1	A2	A3	A1-A3	A4	A5	B1	B2	B3	B4	B5	B6	B7	C1	C2	C3	C4	D
Components for re-use	kg	0.00E+00	0.00E+00	0.00E+00	0.00E+00	MND	0.00E+00	MND	MND	MND	MND	MND	MND	MND	0.00E+00	0.00E+00	0.00E+00	0.00E+00	0.00E+00
Materials for recycling	kg	0.00E+00	0.00E+00	0.00E+00	0.00E+00	MND	0.00E+00	MND	MND	MND	MND	MND	MND	MND	0.00E+00	0.00E+00	1.63E+01	0.00E+00	0.00E+00
Materials for energy rec	kg	0.00E+00	0.00E+00	0.00E+00	0.00E+00	MND	0.00E+00	MND	MND	MND	MND	MND	MND	MND	0.00E+00	0.00E+00	1.90E+00	0.00E+00	0.00E+00
Exported energy	MJ	0.00E+00	0.00E+00	0.00E+00	0.00E+00	MND	0.00E+00	MND	MND	MND	MND	MND	MND	MND	0.00E+00	0.00E+00	0.00E+00	0.00E+00	0.00E+00

### ENVIRONMENTAL IMPACTS – EN 15804+A1, CML / ISO 21930

Impact category	Unit	A1	A2	A3	A1-A3	A4	A5	B1	B2	B3	B4	B5	B6	B7	C1	C2	C3	C4	D
Global Warming Pot.	kg CO <sub>2</sub> e	2.39E+02	3.79E+00	1.45E+01	2.57E+02	MND	0.00E+00	MND	MND	MND	MND	MND	MND	MND	4.07E-01	0.00E+00	4.42E-01	1.25E+00	-3.15E+01
Ozone depletion Pot.	kg CFC-11e	1.86E-05	7.25E-07	6.81E-07	2.00E-05	MND	0.00E+00	MND	MND	MND	MND	MND	MND	MND	1.04E-08	0.00E+00	3.71E-08	1.25E-07	-2.20E-06
Acidification	kg SO <sub>2</sub> e	1.65E+00	1.24E-02	7.82E-02	1.74E+00	MND	0.00E+00	MND	MND	MND	MND	MND	MND	MND	1.53E-03	0.00E+00	4.00E-03	3.22E-03	-3.02E-01
Eutrophication	kg PO <sub>4</sub> <sup>3</sup> e	4.54E-01	2.77E-03	1.84E-02	4.75E-01	MND	0.00E+00	MND	MND	MND	MND	MND	MND	MND	1.89E-03	0.00E+00	1.26E-03	5.97E-02	-4.02E-02
POCP ("smog")	kg C <sub>2</sub> H <sub>4</sub> e	7.83E-02	4.87E-04	2.88E-03	8.16E-02	MND	0.00E+00	MND	MND	MND	MND	MND	MND	MND	6.61E-05	0.00E+00	1.53E-04	2.49E-04	-2.39E-02
ADP-elements	kg Sbe	1.39E-03	8.74E-06	1.85E-05	1.42E-03	MND	0.00E+00	MND	MND	MND	MND	MND	MND	MND	2.28E-06	0.00E+00	4.80E-05	1.55E-06	-6.49E-05
ADP-fossil	MJ	2.90E+03	5.86E+01	2.38E+02	3.19E+03	MND	0.00E+00	MND	MND	MND	MND	MND	MND	MND	5.10E+00	0.00E+00	5.38E+00	1.15E+01	-2.65E+02

### ENVIRONMENTAL IMPACTS – TRACI 2.1. / ISO 21930

Impact category	Unit	A1	A2	A3	A1-A3	A4	A5	B1	B2	B3	B4	B5	B6	B7	C1	C2	C3	C4	D
Global Warming Pot.	kg CO <sub>2</sub> e	2.37E+02	3.80E+00	1.45E+01	2.55E+02	MND	0.00E+00	MND	MND	MND	MND	MND	MND	MND	4.03E-01	0.00E+00	4.39E-01	1.13E+00	-3.12E+01
Ozone Depletion	kg CFC <sub>11</sub> e	1.85E-05	7.24E-07	9.14E-07	2.01E-05	MND	0.00E+00	MND	MND	MND	MND	MND	MND	MND	1.03E-08	0.00E+00	3.69E-08	1.24E-07	-2.20E-06
Acidification	kg SO <sub>2</sub> e	8.57E+01	7.62E-01	2.51E-01	8.67E+01	MND	0.00E+00	MND	MND	MND	MND	MND	MND	MND	7.73E-02	0.00E+00	2.24E-01	2.12E-01	-1.48E+01
Eutrophication	kg Ne	6.49E-02	1.65E-03	5.39E-03	7.19E-02	MND	0.00E+00	MND	MND	MND	MND	MND	MND	MND	3.14E-05	0.00E+00	1.82E-04	1.56E-03	-3.35E-04
POCP ("smog")	kg O <sub>3</sub> e	7.11E-01	1.25E-02	8.91E-01	1.61E+00	MND	0.00E+00	MND	MND	MND	MND	MND	MND	MND	5.48E-04	0.00E+00	2.69E-03	3.89E-03	-9.02E-02
ADP-fossil	MJ	2.33E+02	8.11E+00	2.02E+01	2.62E+02	MND	0.00E+00	MND	MND	MND	MND	MND	MND	MND	2.24E-01	0.00E+00	5.25E-01	1.57E+00	-2.47E+01

## VERIFICATION STATEMENT

### VERIFICATION PROCESS FOR THIS EPD

This EPD has been verified in accordance with ISO 14025 by an independent, third-party verifier by reviewing results, documents and compliancy with reference standard, ISO 14025 and ISO 14040/14044, following the process and checklists of the program operator for:

- This Environmental Product Declaration
- The Life-Cycle Assessment used in this EPD
- The digital background data for this EPD

Why does verification transparency matter? [Read more online](#)

This EPD has been generated by One Click LCA EPD generator, which has been verified and approved by the EPD Hub.

### THIRD-PARTY VERIFICATION STATEMENT

I hereby confirm that, following detailed examination, I have not established any relevant deviations by the studied Environmental Product Declaration (EPD), its LCA and project report, in terms of the data collected and used in the LCA calculations, the way the LCA-based calculations have been carried out, the presentation of environmental data in the EPD, and other additional environmental information, as present with respect to the procedural and methodological requirements in ISO 14025:2010 and reference standard.

I confirm that the company-specific data has been examined as regards plausibility and consistency; the declaration owner is responsible for its factual integrity and legal compliance.

I confirm that I have sufficient knowledge and experience of construction products, this specific product category, the construction industry, relevant standards, and the geographical area of the EPD to carry out this verification.

I confirm my independence in my role as verifier; I have not been involved in the execution of the LCA or in the development of the declaration and have no conflicts of interest regarding this verification.

Neena Chandramathy, as an authorized verifier acting for EPD Hub Limited  
16.04.2024

